

GLOBAL HUMANITARIAN MISSION

PROJECT PROPOSAL EL RODEO CLINIC



El Rodeo, Guayape HONDURAS

Overview

Bordering Guatemala, El Salvador and Nicaragua, Honduras is one of the poorest Spanish-speaking countries in the Western Hemisphere. Nearly 65% of Honduras' population of approximately 9 million people live in poverty.

The poverty index continues to increase every year, according to INE, reaching 74 percent on average in 2022, and 79 percent in rural areas. The country has not been able to recover from the COVID-19 pandemic, followed by hurricanes Eta and Iota in 2020.

Honduras has the highest income inequality of all of Latin America. Almost 49 percent of the Honduran population lives below the poverty line, existing on less than \$2 per day. Most families can only afford to eat twice a day.

Local non-profit organization, CEPUDO, collaborates with international organizations to work with communities in Honduras, assisting families to overcome conditions of extreme poverty. CEPUDO has been instrumental in establishing fully developed communities, strengthening a spirit of solidarity and self-sustainability through donated material goods, development of productive projects, training and technical assistance.

Situated in the municipality of Guayape, within the department of Olancho, the community of El Rodeo serves as a significant regional agricultural hub. Here, residents toil strenuously in the fields to secure sustenance. livestock thrive, and typical crops cultivated include corn, beans, coffee, sugar cane, fruits, and horticulture.

Despite its thriving agricultural industry, El Rodeo is marked by widespread poverty, with inhabitants facing inadequate living conditions. Additionally, children continuously grapple with illnesses like cough and flu, due to the chilly nighttime temperatures, as well as diarrhea due to unsanitary living conditions.

In the municipality of Guayape, the population is 13,665 people which is made up of 6,848 men and 6,817 women. It is estimated that children represent 34.44%, adults 55.55% and the elderly 10.01%.



Residents work their plots and plant corn

Where They Are



Coordinates: 14.2833° N, 86.6000° W

Project Snapshot

Global Humanitarian Mission is heeding the urgent call from CEPUDO, and seeks your partnership in bringing basic healthcare services to desperately poor families in rural Honduras.

In response to the obvious need, **GHM** is establishing this project that will benefit about **3,000** residents from the village of El Rodeo and the surrounding area.

The local municipality has committed to setting aside funds for a medical staff and for the clinic's upkeep. Services at the clinic will include general medical consultations, care for chronic degenerative diseases, and remedies for infectious respiratory and digestive illnesses.

The new El Rodeo clinic will include the construction of a 1,721 sq. ft. structure on land contributed by the community. An old home situated on the land will be demolished to make room for the clinic.

The clinic will be equipped with:

- Patient waiting room
- 2 Examination rooms
- Observation room
- Pharmacy
- Storage room
- Patient bathrooms - 2 Males and 2 Females
- 2 Staff bathrooms

Residents will be able to attend health education programs at the clinic to raise awareness about healthy lifestyles, proper nutrition, and disease prevention.

With no such clinic in the vicinity, it takes residents approximately two hours to travel the mountainous terrain, either by foot or horse, to seek medical attention.

In some communities, children are not vaccinated in about a year.

TOTAL COST: \$72,533.16

The Plan

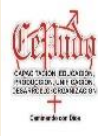
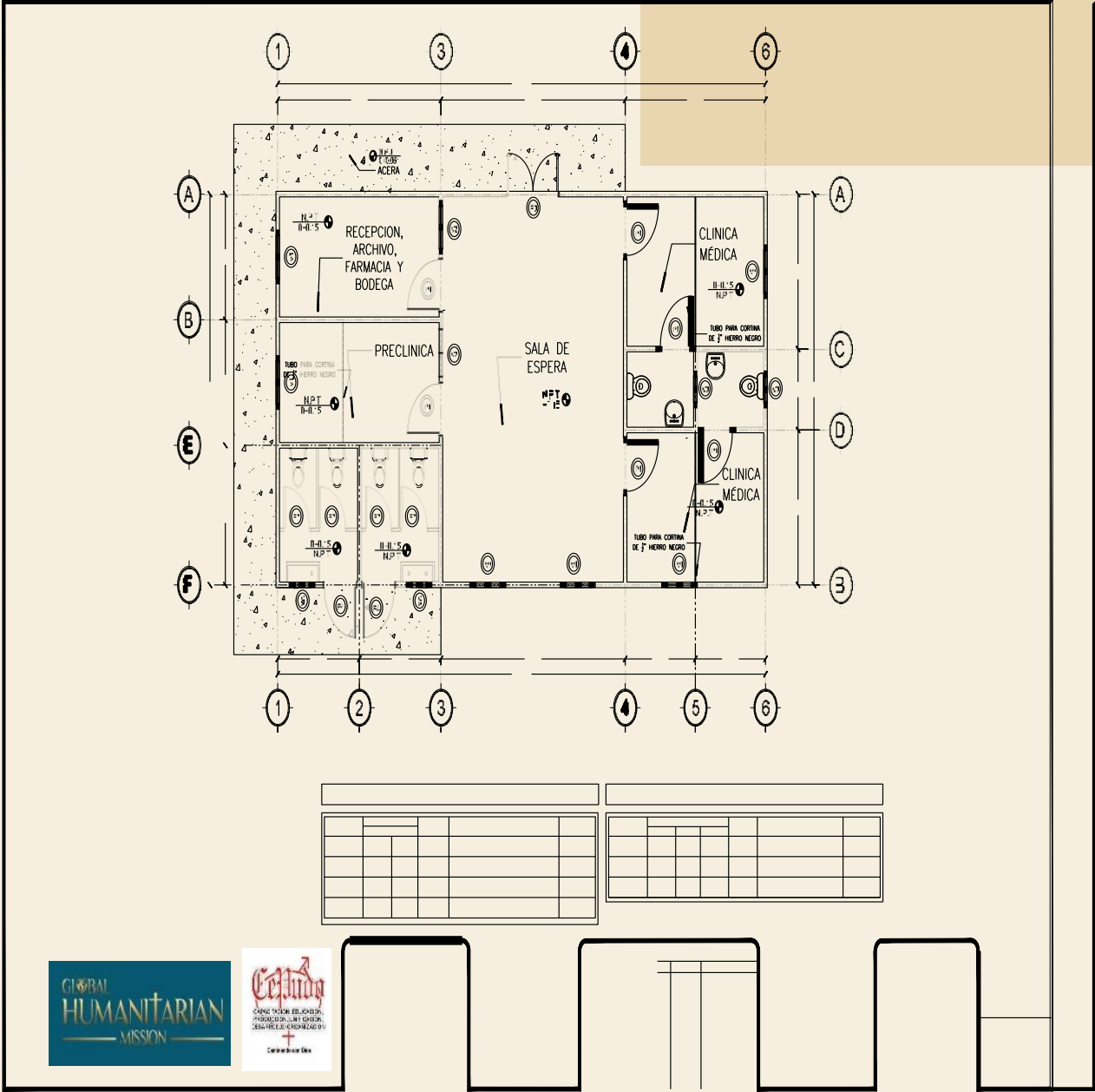

We Need You

Global Humanitarian Mission urgently seeks your partnership in bringing basic healthcare to this rural region of Honduras.

Your help will mean the difference between life and death for humble folk who have had to manage the best way they know how without basic health care!



Mayor of Guayape, Issis Nuñez Sanchez is grateful for the prospect of a clinic in the community, stating, "El Rodeo is a community in need of a clinic. The inhabitants have had this dream of having this clinic in their community. These people have to walk for a long time to receive medical attention. A clinic is necessary to be able to provide better care and ensure that they are in good health."



Hilda, a resident of El Rodeo Community, has this to say: "Sometimes older people find it difficult to be cared for and are carried on horses or in hammocks by the same people from the communities. When we have emergencies, we cannot go to a nearby clinic. This clinic is a project that the community needs, we hope you will support us and provide us with this project for our children. Thank you so much!"

***"Hear me, Lord, and answer me, for I am poor and needy.
Hear my prayer, Lord; listen to my cry for mercy.
When I am in distress, I call to you, because you answer me." Psalm 86:1, 6, 7***

Global Humanitarian Mission, a 501(c)(3) organization, is comprised of a compassionate and committed team with over thirty years' experience working in international relief and development around the globe. Global Humanitarian Mission honors the intent of our donors. All proceeds are restricted for the specific project for which they are raised. If more funds are received than are required for a specific project, the additional funds will be used to meet the most urgent need.